



MONITORING AND CONTROL SOLUTIONS

Adding the SenseItCloud
shortcut to your home screen
Apple and Android devices



iPad and iPhone



iPad and iPhone

STEP 1:

Open Safari Browser and go to <https://senseitcloud.co.za>

This does not work from the "Chrome" App in iPhones

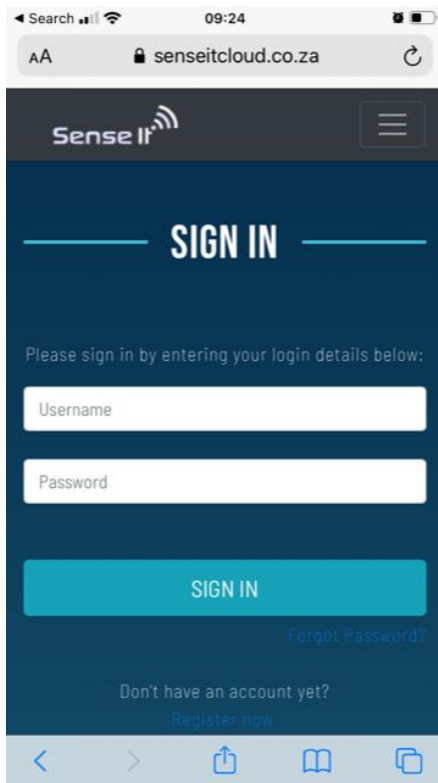

STEP 2:

Once logged in, click on the share icon at the bottom of the browser

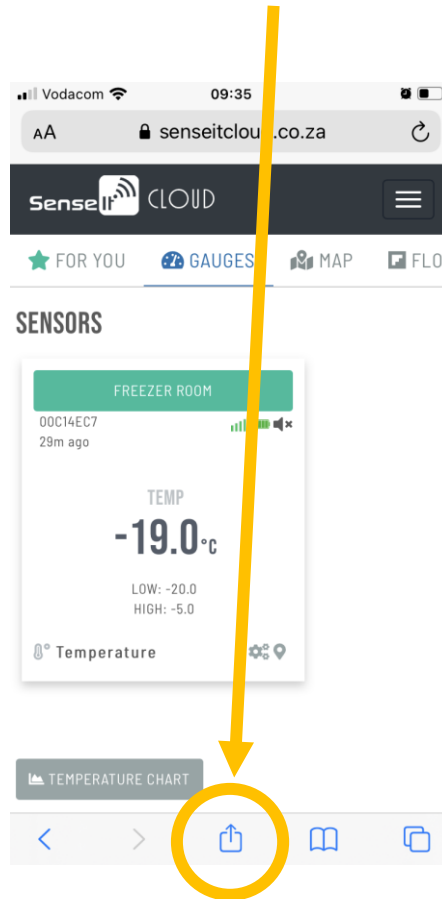

STEP 3:

Scroll down and click on "Add to Home Screen"

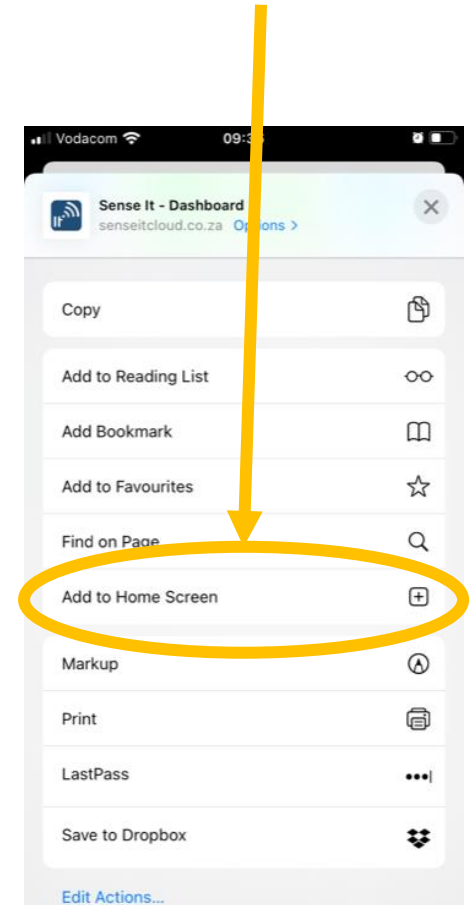



iPad and iPhone

STEP 4:
Click on "Add"

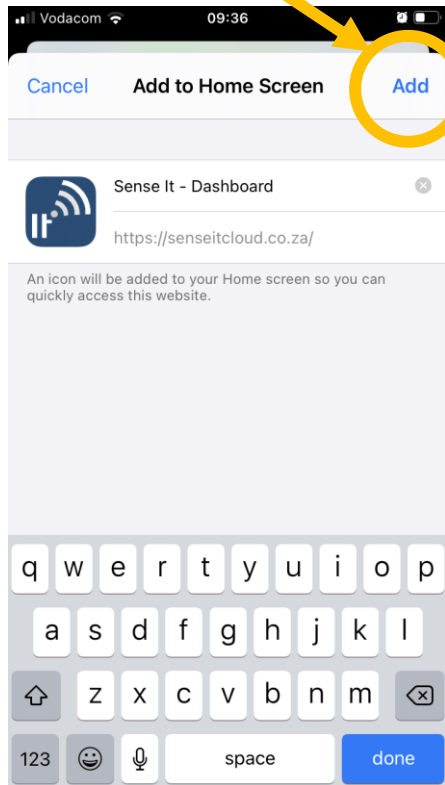

STEP 5:
The Sense It icon should now be on your home screen

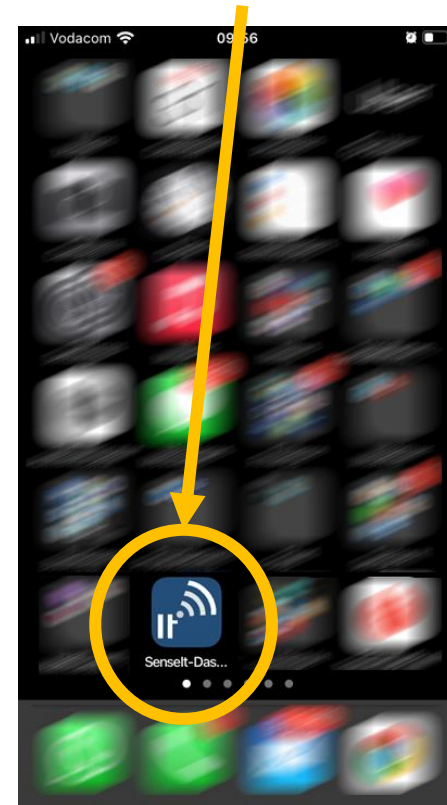



Android



Android

STEP 1:

Open Chrome Browser and go to <https://senseitcloud.co.za>

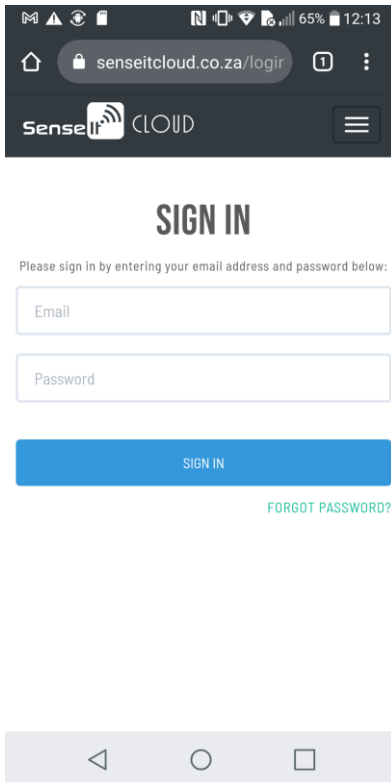

STEP 2:

Once logged in, click on the 3 dots at the top of the browser

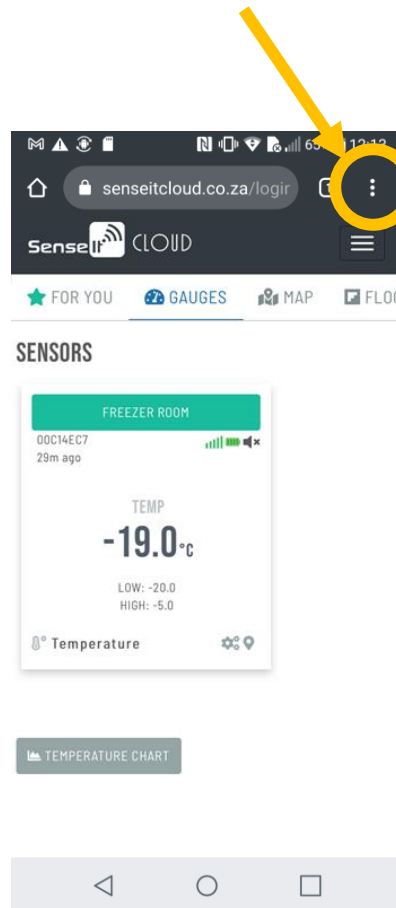

STEP 3:

Scroll down and click on "Add to Home Screen" or "Install App" on newer models

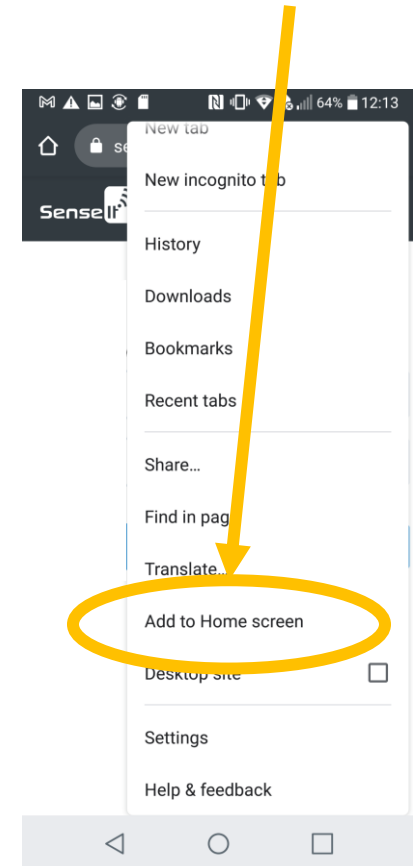



Android

STEP 4:
Click on "Add"

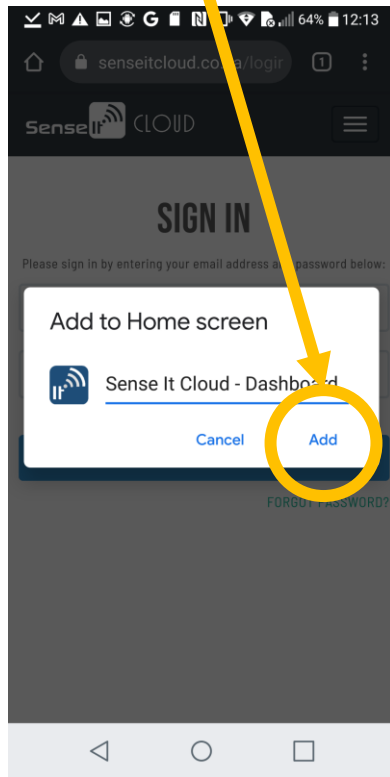

STEP 5:
The Sense It icon should now be on your home screen

